

# **INTRAAX®-SP**

## **AAZNT 23K / AAZNT 46K AAZL 23K / AAZL 46K Specifications**

LIT NO: L840

DATE: April 2007

REVISION: A

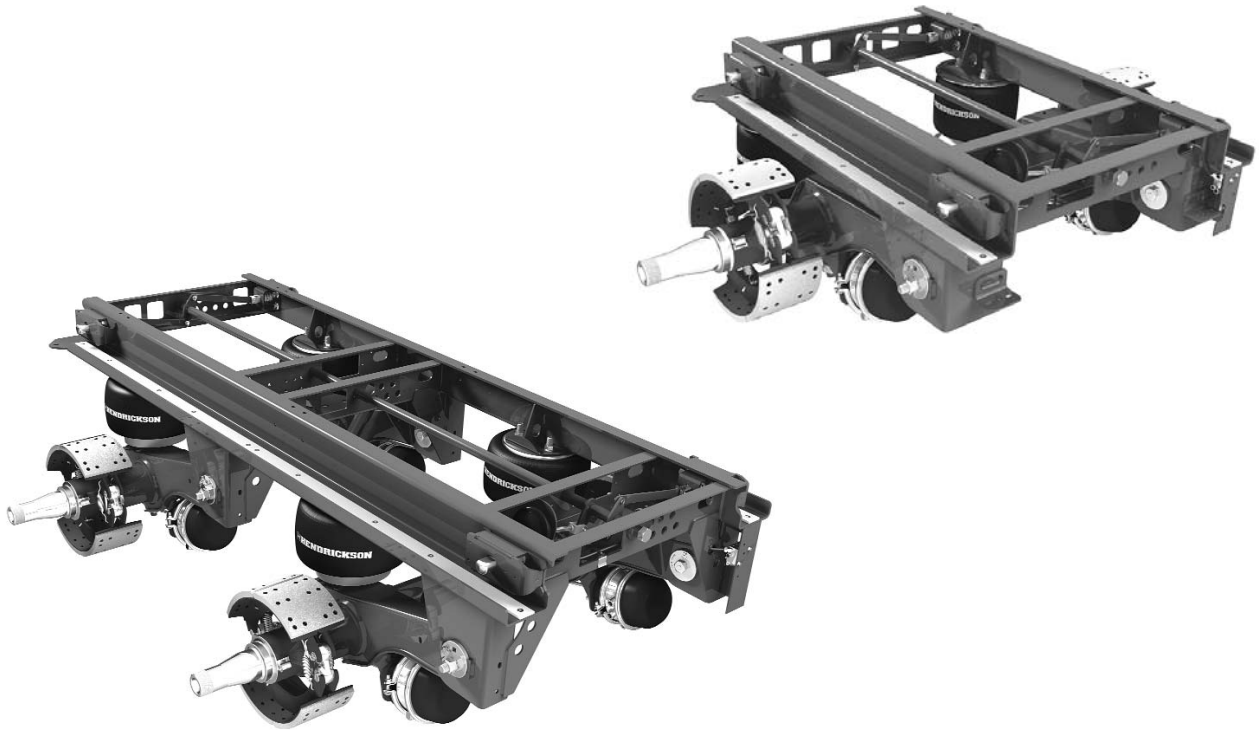

### **TABLE OF CONTENTS**

#### **SPECIFICATIONS**

AAZNT 23K / AAZNT 46K .....	2-3
AAZL 23K / AAZL 46K .....	4-5
Axle .....	6
Brake Options .....	6
Brake Chambers .....	6
Brake Adjusters .....	6
READY-TO-ROLL® (RTR®) .....	6

<b>OPTIONS</b> .....	7
----------------------	---

**AAZNT 23K****AAZNT 46K**

<b>* SYSTEM CAPACITY</b>	23,000 lbs. (10 400 kg)	46,000 lbs. (20 700 kg)
<b>APPLICATION</b>	On-highway	On-highway
<b>TRAILER TYPES</b>	<b>U.S.A. &amp; CANADA</b> Platform <hr/> <b>MEXICO, CENTRAL &amp; SOUTH AMERICA</b> None	<b>U.S.A. &amp; CANADA</b> Platform <hr/> <b>MEXICO, CENTRAL &amp; SOUTH AMERICA</b> None
<b>FRAME TYPES</b>	Trailer width: 96 or 102 inch I-beam centers: 37, 38, 43 or 44 inch Bottom flange width: 4, 4.5 or 5 inch	Trailer width: 96 or 102 inch I-beam centers: 37, 38, 43 or 44 inch Bottom flange width: 4, 4.5 or 5 inch
<b>AXLE DATA</b>	<b>Arrangement:</b> Single <b>Spacing:</b> N/A <b>Diameter:</b> 5.75 inch large-diameter axle (LDA™) <b>Track:</b> 71.5 and 77.5 inch	<b>Arrangement:</b> Tandem <b>Spacing:</b> 49-, 60- and 72-inch spreads <b>Diameter:</b> 5.75 inch large-diameter axle (LDA™) <b>Track:</b> 71.5 and 77.5 inch
<b>BASE MODEL DESCRIPTION</b>	AAZNT platform slider suspension system consisting of Z-rail slider box designed for 37-inch I-beam centers with 14-inch ride height INTRAAX® suspension(s), 71.5-inch axle track, HN spindles, standard shock absorbers, 16.5 × 7-inch brakes with Abex 3030-197 brake lining, ABS brackets and QUIK-ALIGN®. QUIK-DRAW® pneumatic pin-pull mechanism and Cam Tube System™ standard.	
<b>OPTIONS</b>	Additional options include slider box shims for use on trailers with outer web reinforcement plates. Extended-service / high-damping shock absorbers and shock straps. Ride heights ranging from 13.5 to 17 inches, as well as HP spindles and dust shields. Contact your Hendrickson representative to discuss these and other options, including a variety of READY-TO-ROLL® (RTR®) brake and wheel-end packages.	

\*System capacity refers to the suspension, axle and slider. Ratings for brakes and wheel-end components differ depending upon options chosen.

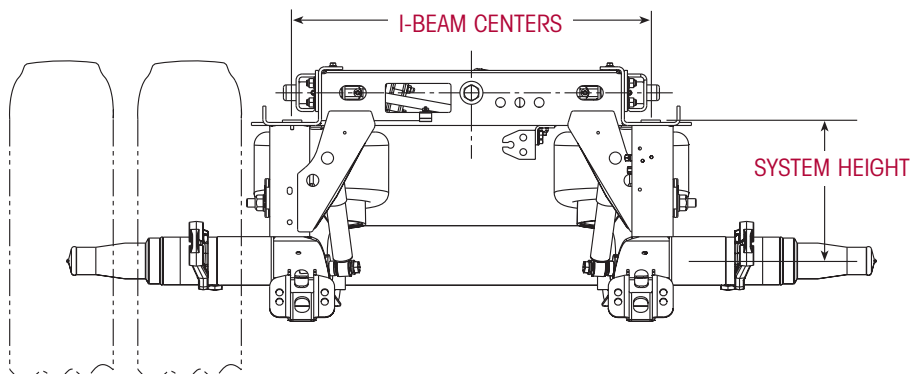



## AAZNT 23K

RIDE HEIGHT (inches)	SYSTEM HEIGHT (inches)	FRONT AXLE LOCATION (inches)	JOUNCE (inches)	REBOUND (inches)	WEIGHT* (pounds)
13.5	14	26.5	3.3	5.4	758
14	14.5	26.4	3.8	4.9	758
15	15.5	26	3.8	3.9	759
16	16.5	26.4	3.8	4.7	768
17	17.5	26	3.9	3.7	774

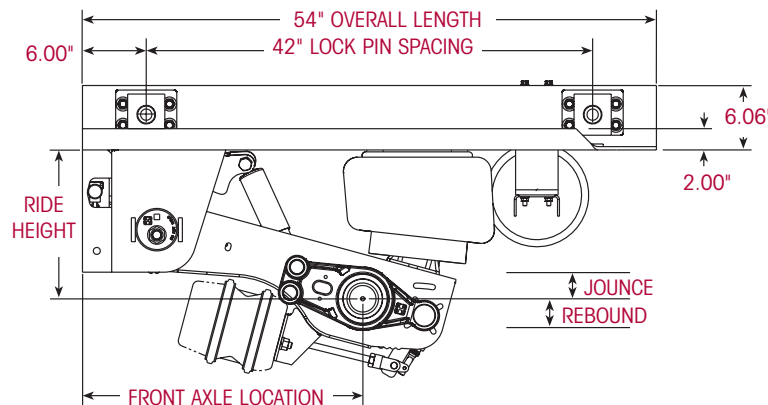

\*Weights reflect base model specifications. For 38-inch I-beam centers, add 2 pounds. For 43-inch I-beam centers, add 20 pounds. For 44-in. I-beam centers, add 22 pounds.

## AAZNT 46K

RIDE HEIGHT (inches)	SYSTEM HEIGHT (inches)	FRONT AXLE LOCATION (inches)	JOUNCE (inches)	REBOUND (inches)	WEIGHT* (pounds)		
					49" Spread	60" Spread	72" Spread
13.5	14	26.5	3.3	5.4	1428	1462	1495
14	14.5	26.4	3.8	4.9	1428	1462	1495
15	15.5	26	3.8	3.9	1431	1464	1498
16	16.5	26.4	3.8	4.7	1448	1482	1515
17	17.5	26	3.9	3.7	1459	1493	1527

AXLE SPACING (inches)	OVERALL LENGTH (inches)	LOCK PIN SPACING (inches)
49	102	90
60	114	102
72	126	114

\* Weights reflect base model specifications. For 38-inch I-beam centers, add 3.84 pounds. For 43-inch I-beam centers, add 37 pounds. For 44-inch I-beam centers, add 41 pounds.

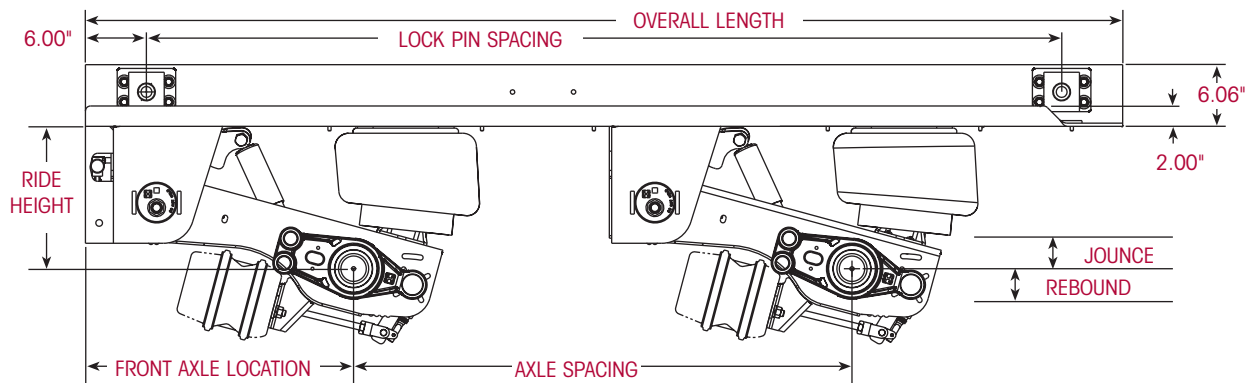

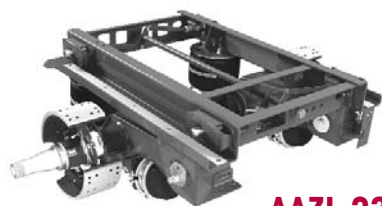
**AAZL 23K****AAZL 46K**

<b>* SYSTEM CAPACITY</b>	23,000 lbs. (10 400 kg)	46,000 lbs. (20 700 kg)
<b>APPLICATION</b>	On-highway	On-highway
<b>TRAILER TYPES</b>	<b>U.S.A. &amp; CANADA</b> Platform, Drop Deck  <b>MEXICO, CENTRAL &amp; SOUTH AMERICA</b> None	<b>U.S.A. &amp; CANADA</b> Platform, Drop Deck  <b>MEXICO, CENTRAL &amp; SOUTH AMERICA</b> None
<b>FRAME TYPES</b>	Trailer width: 96 or 102 inch I-beam centers: 37, 38, 43 or 44 inch Bottom flange width: 4, 4.5 or 5 inch	Trailer width: 96 or 102 inch I-beam centers: 37, 38, 43 or 44 inch Bottom flange width: 4, 4.5 or 5 inch
<b>AXLE DATA</b>	<b>Arrangement:</b> Single <b>Spacing:</b> N/A <b>Diameter:</b> 5 inch <b>Track:</b> 71.5 and 77.5 inch	<b>Arrangement:</b> Tandem <b>Spacing:</b> 49-, 60- and 72-inch spreads <b>Diameter:</b> 5 inch <b>Track:</b> 71.5 and 77.5 inch
<b>BASE MODEL DESCRIPTION</b>	AAZL platform slider suspension system consisting of Z-rail slider box designed for 37-inch I-beam centers with 6.5-inch ride height INTRAAX® suspension(s), 71.5-inch axle track, HN spindles, standard shock absorbers, 16.5 × 7-inch brakes with Abex 3030-197 brake lining, ABS brackets and QUIK-ALIGN®. QUIK-DRAW® pneumatic pin-pull mechanism and Cam Tube System™ standard.	
<b>OPTIONS</b>	Additional options include slider box shims for use on trailers with outer web reinforcement plates. Extended-service / high-damping shock absorbers and shock straps. Ride heights ranging from 6.5 to 12 inches, as well as HP spindles and dust shields. Contact your Hendrickson representative to discuss these and other options, including a variety of READY-TO-ROLL® (RTR®) brake and wheel-end packages.	

\*System capacity refers to the suspension, axle and slider. Ratings for brakes and wheel-end components differ depending upon options chosen.

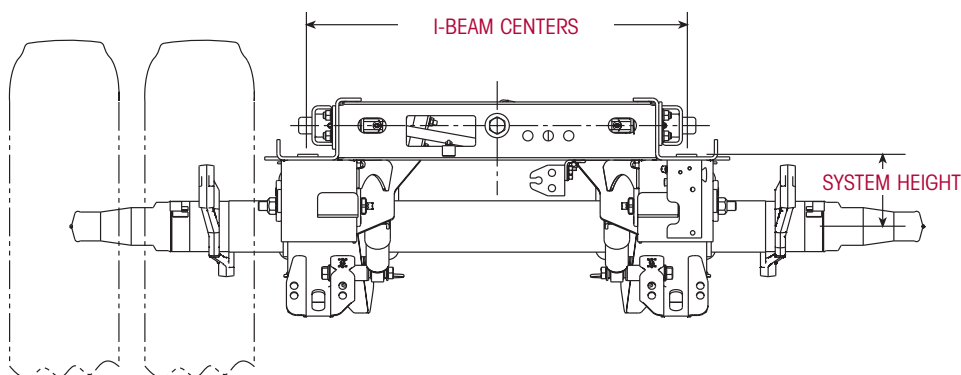



## AAZL 23K

RIDE HEIGHT (inches)	SYSTEM HEIGHT (inches)	FRONT AXLE LOCATION (inches)	JOUNCE (inches)	REBOUND (inches)	WEIGHT* (pounds)
6.5	7	26.4	2.3	4.5	845
7.5	8	26.4	3.3	3.5	845
8	8.5	26.2	3.8	5.2	845
9	9.5	26	4.8	4.2	845
12	12.5	26.1	5.3	4.8	862

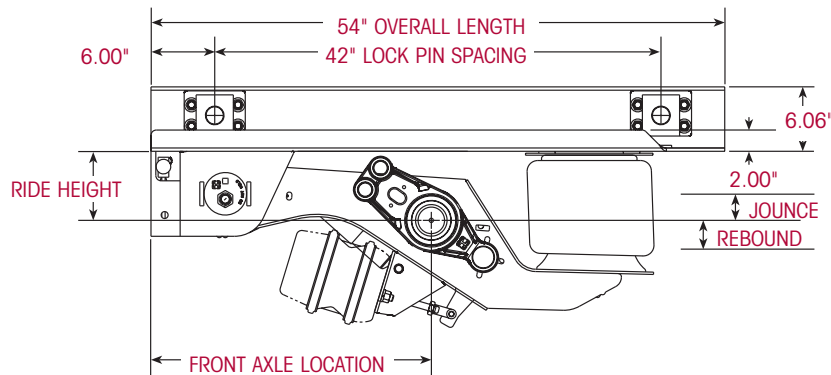

\*Weights reflect base model specifications. For 38-inch I-beam centers, add 2 pounds. For 43-inch I-beam centers, add 24 pounds. For 44-inch I-beam centers, add 26 pounds.

## AAZL 46K

RIDE HEIGHT (inches)	SYSTEM HEIGHT (inches)	FRONT AXLE LOCATION (inches)	JOUNCE (inches)	REBOUND (inches)	WEIGHT* (pounds)		
					49" Spread	60" Spread	72" Spread
6.5	7	26.4	2.3	4.5	1601	1637	1671
7.5	8	26.4	3.3	3.5	1601	1637	1671
8	8.5	26.2	3.8	5.2	1601	1637	1671
9	9.5	26	4.8	4.2	1601	1637	1671
12	12.5	26.1	5.3	4.8	1635	1671	1704

AXLE SPACING (inches)	OVERALL LENGTH (inches)	LOCK PIN SPACING (inches)
49	102	90
60	114	102
72	126	114

\*Weights reflect base model specifications. For 38-inch I-beam centers, add 3 pounds. For 43-inch I-beam centers, add 45 pounds. For 44-inch I-beam centers, add 49 pounds.

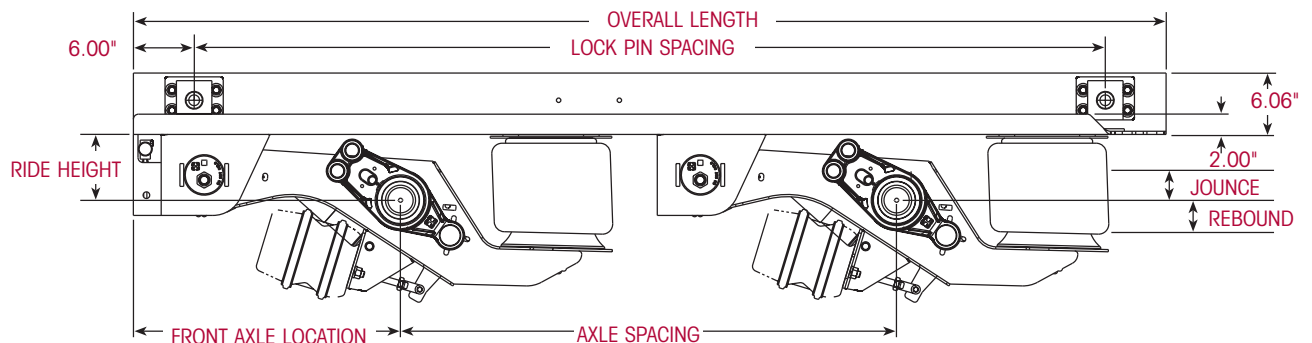

**AXLE**

SPINDLE TYPE	BEARINGS				TUBE O.D. (inches)
	INNER CONE	OUTER CONE	INNER CUP	OUTER CUP	
HN	HM218248	HM212049	HM218210	HM212011	5.75
HP	HM518445	HM518445	HM518410	HM518410	5.75

**BRAKE OPTIONS**

For complete details of the wide range of brake options available including lining choices, brake ratings FMVSS / CMVSS 121 brake certifications and air disc options, refer to publication L809 *Brake Specifications*.

**BRAKE CHAMBERS**

Industry standard brake chambers with pushrod length of 9.75 inches and clamping / port orientation of zero degrees are compatible with all top mount (AAZNT) models. A pushrod length of 5.63 inches and clamping / port orientation of zero degrees is required for the low ride (AAZL) models.

**BRAKE ADJUSTERS**

Industry standard 5.5- and 6-in. brake adjusters are compatible.

**READY-TO-ROLL® (RTR®)**

Choose from a broad mix of offerings to customize running gear for your specific application. Wheel-end options consist of aluminum, ductile iron or ADI in a variety of standard and extended service packages.



## OPTIONS

### STINGER

Bolt-on bracket available in 24-inch length.

### MUD FLAP MOUNTING ANGLE

Bolt-on bracket attaches to rear cross member.

### BOLT-ON AIR TANK BRACKET KITS

For use with industry standard jumbo or small tanks.

### SINGLE-AXLE SLIDER REPOSITIONING KIT

Recommended for all single-axle sliders used in conjunction with fixed suspensions. The kit locks the brakes and dumps the air on the sliding axle for ease of repositioning.

### HEIGHT CONTROL VALVE KITS

Standard height control valve (HCV) kits, as well as HCV kits with auto dump valves, are available for use with the AAZ sliders on straight platform trailers. A special HCV kit with a raise feature is recommended when using an AAZL slider with a fixed suspension on a drop-deck trailer with wheelhouses. The kit locks the brakes, dumps the air on the sliding axle(s) and raises the trailer deck by adding air to the fixed suspension. The AAZL slider can then be moved to its new location by repositioning the trailer.

### UNIVERSAL LOAD SCALE KITS

Provide accurate axle loading readings; available in both dry and liquid-filled gauge models.

---

[www.hendrickson-intl.com](http://www.hendrickson-intl.com)

---



Trailer Suspension Systems  
250 Chrysler Drive, Unit #3  
Brampton, ON Canada L6S 6B6  
905.789.1030  
Fax 905.789.1033

Trailer Suspension Systems      866.RIDEAIR (743.3247)  
2070 Industrial Place SE      330.489.0045  
Canton, OH 44707-2641 USA      Fax 800.696.4416

Trailer Suspension Systems  
Av. Industria Automotriz #200  
Parque Industrial Siva Aeropuerto  
Apodaca, N.L., México C.P. 66600  
(52) 81 8288 1300  
Fax (52) 81 8288 1301