

HT™ SERIES

HT250U-Y SPECIFICATIONS

LIT NO: L34

DATE: September 2009

REVISION: B

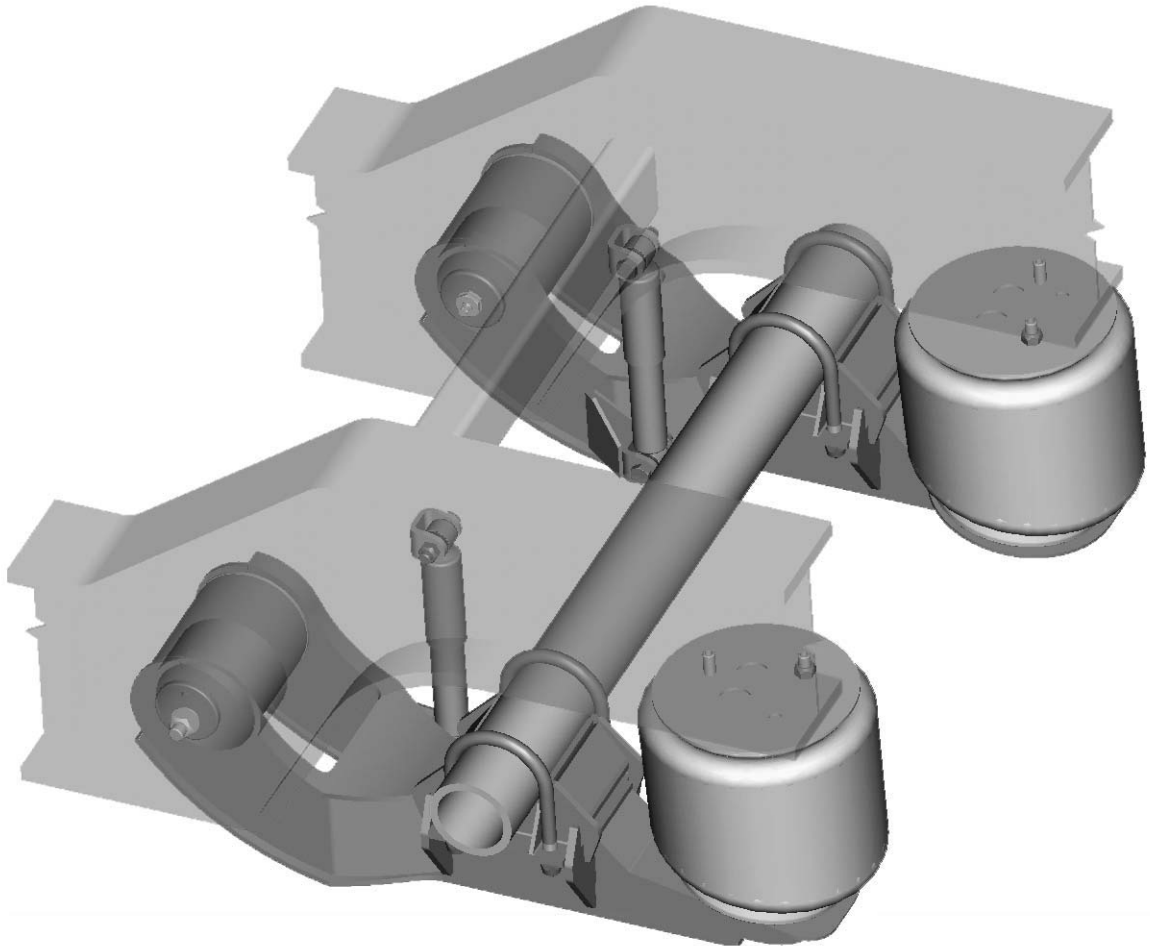



APPLICATIONS

CAPACITY:	25,000 lbs. (11,300 kg)	
TRAILER TYPES:	UNITED STATES AND CANADA Lowboy / Drop Deck Specialty Trailers	MEXICO, CENTRAL AND SOUTH AMERICA None
AXLE DATA:	5-inch diameter round, 5/8-inch wall, S-cam or disk brakes, w/ or w/o auto slack adjusters for 15-, 20- or 22-inch wheels	
AXLE ARRANGEMENT:	Single; tandem: 122-inch maximum axle spacing Tri or quad: 144-inch maximum total spacing	
FRAME TYPES:	Steel or aluminum; 96-inch or 102-inch wide trailers	

MODEL CHART

SUSPENSION MODEL NUMBER	RIDE HEIGHT (inches)	JOUNCE (inches)	REBOUND (inches)	WEIGHT (pounds) ¹
HT250U-6.5Y-006	6.5	3.7	4.2	463
HT250U-9Y-006	9	5.1	4.2	463
HT250YB-6.5-006	6.5	3.7	4.2	459
HT250YB-7.5-006	7.5	4.3	4.2	459
HT250YB-9-006	9	5.1	4.2	459

¹Weights shown are for the standard model (standard shock and air spring) and do not include the axle.

HT250U-Y models feature welded collar pivot connection.

HT250YB models feature QUIK-ALIGN® pivot connection.

Options available: high damp shocks, shock limit straps, rotated air spring and high pressure air spring.

SUSPENSION APPLICATION NOTE:

Care must be taken to insure that any additional suspensions used on the same vehicle are compatible with the Y-beam suspension. For assistance, please contact your Hendrickson Trailer Suspension Systems customer service representative.

www.hendrickson-intl.com



Trailer Suspension Systems
250 Chrysler Drive, Unit #3
Brampton, ON Canada L6S 6B6
905.789.1030
Fax 905.789.1033

Trailer Suspension Systems 866.RIDEAIR (743.3247)
2070 Industrial Place SE 330.489.0045
Canton, OH 44707-2641 USA Fax 800.696.4416

Hendrickson Mexicana
Av. Industria Automotriz #200
Parque Industrial Sliva Aeropuerto
Apodaca, N.L., México C.P. 66600
+52 (81) 8288.1300
Fax +52 (81) 8288.1301