

HENDRICKSON VANTRAAX®/QUIK-DRAW® OPERATING INSTRUCTIONS

⚠ WARNING

Unsecured slider box can cause loss of vehicle control, which can result in death, serious injury or property damage. Use the following procedure to properly secure the slider box to the body rails.

TO REPOSITION THE SLIDER:

1. **On a level surface, apply only the trailer parking brakes.**
2. Remove the manual stop bar (if used on this trailer) and move it to the desired position.
3. Retract the locking pins by pulling the QUIK-DRAW valve knob out (**never force or use tools on knob**).
4. Gently rock the trailer fore and aft to fully retract bound pins.
5. Move the slider to the desired position by carefully moving the trailer until the slider is in the desired position. **Trailer parking brakes must remain applied.**
6. Engage the locking pins by pushing the QUIK-DRAW valve knob in.
7. Visually check all locking pins for proper engagement — the chamfered ends of the locking pins must project through the body rail at all four locations.
8. Install the manual stop bar directly behind the slider system.
9. Check pin engagement by gently rocking the trailer fore and aft.

Valve position (out) when pins released (**trailer parking brakes must be applied**)

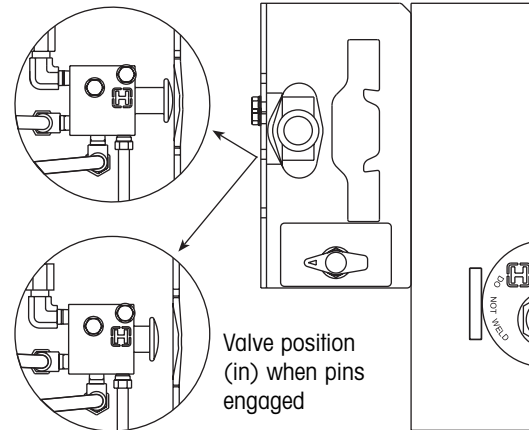

2070 Industrial Place SE
Canton, Ohio 44707-2600 USA
Phone 800 455-0043
(330) 489-0045
Fax 800 696-4416

HENDRICKSON

250 Chrysler Drive, Unit #3
Brampton, Ontario L6S 6B6 CAN
Phone (905) 789-1030
Fax (905) 789-1033

L832 Rev A 08-03
Printed in the United States of America.

www.hendrickson-intl.com

The Boler Company.
Copyright © 2003
Hendrickson Trailer
Suspension Systems
All Rights Reserved